

6200/6300 MP52 series

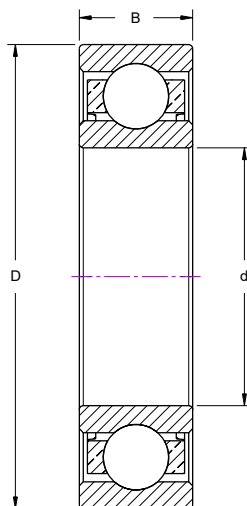

Bearing Number	Dimensions (mm)			Load Rating (lbf)		Limiting Speed (RPM)		Weight (lbs)
				Dynamic	Static	Grease	Oil	
	d	D	B	Cr	Cor			
6206 MP52	30	62	16	4384	2540	10000	13000	0.6
6207 MP52	35	72	17	5778	3440	9000	11000	0.7
6208 MP52	40	80	18	6609	4226	8500	10000	0.9
6209 MP52	45	85	19	7464	4833	7500	9000	1.1
6210 MP52	50	90	20	7891	5216	7000	8500	1.2
6211 MP52	55	100	21	9757	6564	6300	7500	1.6
6212 MP52	60	110	22	10746	7396	6000	7000	2.0
6213 MP52	65	120	23	12859	8992	5300	6300	2.4
6214 MP52	70	125	24	13668	10116	5000	6000	2.8
6215 MP52	75	130	25	14860	11128	4800	5600	3.0
6216 MP52	80	140	26	16096	12207	4500	5300	3.8
6217 MP52	85	150	28	18884	13916	4300	5000	4.5
6307 MP52	35	80	21	7486	4316	8500	10000	1.5
6308 MP52	40	90	23	9172	5395	7500	9000	1.6
6309 MP52	45	100	25	11870	7126	6700	8000	2.1
6310 MP52	50	110	27	13916	8520	6300	7500	2.8
6311 MP52	55	120	29	16096	10071	5600	6700	3.7
6312 MP52	60	130	31	18389	11645	5000	6000	4.6
6313 MP52	65	140	33	20817	13421	4800	5600	5.4
6314 MP52	70	150	35	23403	15287	4500	5300	6.1
6315 MP52	75	160	37	25493	17310	4300	5000	7.9
6316 MP52	80	170	39	27629	19446	3800	4500	9.3
6317 MP52	85	180	41	29832	21717	3600	4300	11.1